

# NISSAN DIESEL AMERICA, INC.

## BODY BUILDER'S BOOK BULLETIN

DATE: OCTOBER 21, 2004  
MODEL YEAR: 2005 AND AFTER  
CHASSIS MODEL: ALL  
BULLETIN NUMBER: BBB-8

### P.T.O. EXTERNAL ENGINE THROTTLE CONTROL

#### PURPOSE

To provide instructions for the External Engine Throttle Control and relays for use in PTO installations that require a remote engine speed control. The information in this bulletin is also available in the 2005 Model Year Body Builder's CD.

#### DESCRIPTION

For vehicles equipped with a PTO, an External Engine Throttle Control, part number 2376036D01, is available through the NDA Parts Operations Department. The engine speed can be controlled externally by connecting the External Engine Throttle Control to the engine ECU via an additional wiring sub-harness, part number 2402437Z04.

#### SUBHARNESS INSTALLATION

1. Attach the extension sub-harness, part number 2402437Z04, to the chassis harness connector as shown below. The extension sub-harness length is approximately 11.5 ft.

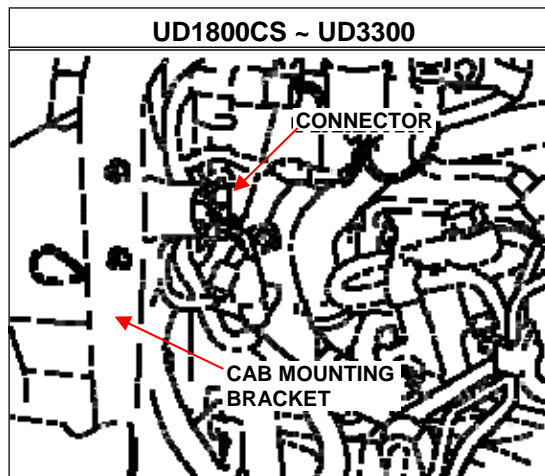

FIGURE 1

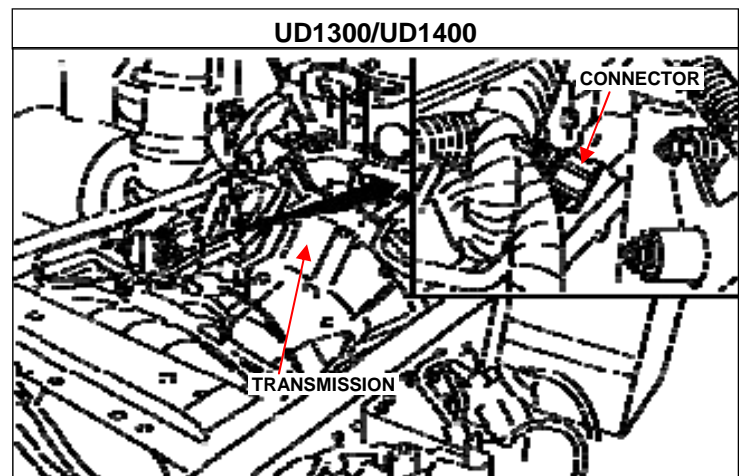
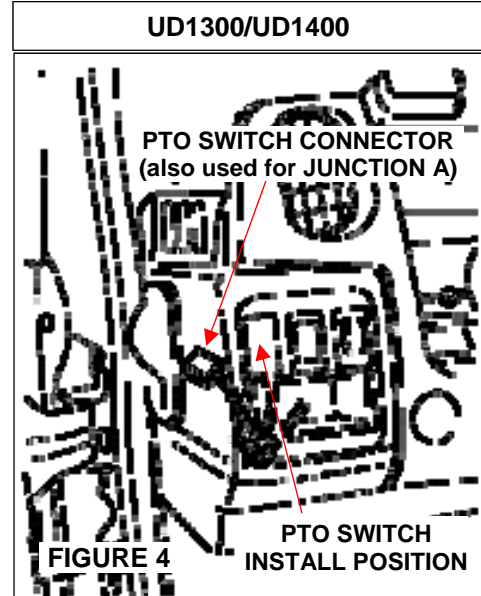
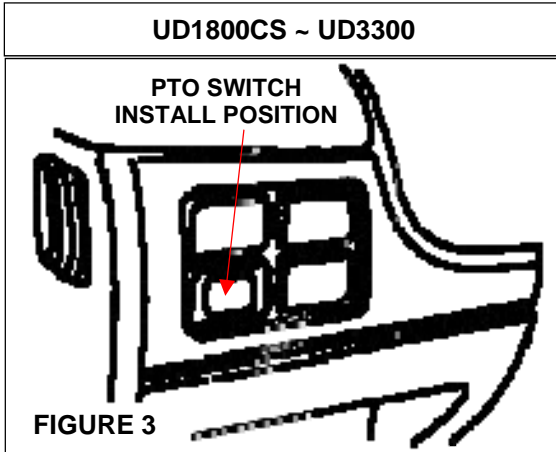

FIGURE 2

2. Route and secure the extension sub-harness as required.

3. Install the PTO switch on the left side dash panel. The PTO switch connector is taped to the instrument harness wiring loom.



### UD1800 ~ UD2600 WITH AUTOMATIC TRANSMISSION

1. Connect the JANC PTO terminals together (found on right, underside of dash panel).

#### EXTERNAL ENGINE THROTTLE CONTROL FUNCTION CHOICE:

- 2a. To operate the External Engine Throttle Control with PTO switch turned "ON" only:
- Connect JANC A terminals together.
- 2b. To operate External Engine Throttle Control with PTO switch turned either "ON" or "OFF":
- Connect JANC A terminals together and JANC B terminals together.

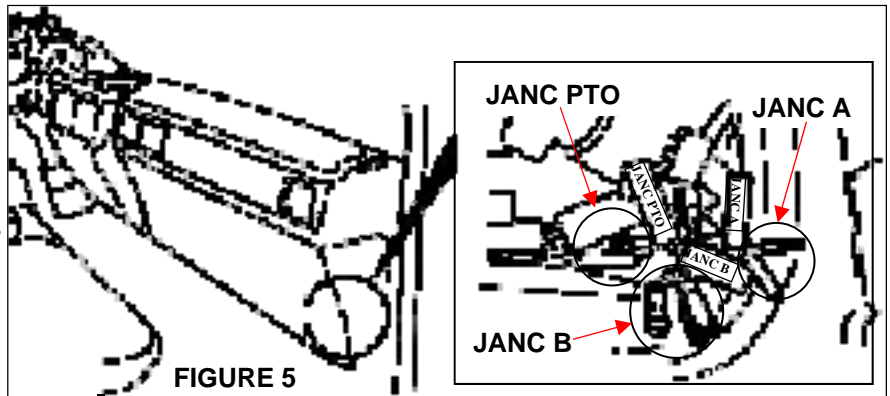

3. Install two (2) PTO relays except

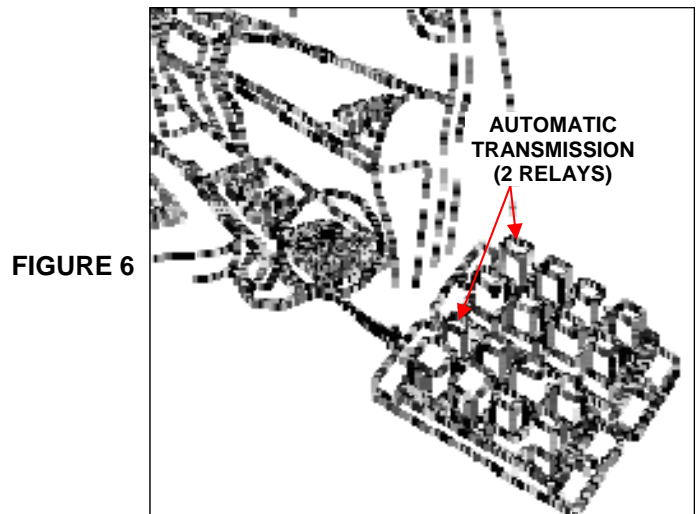

4. Connect the PTO magnetic valve to the chassis wiring harness connector located in the left frame rail near the transmission.

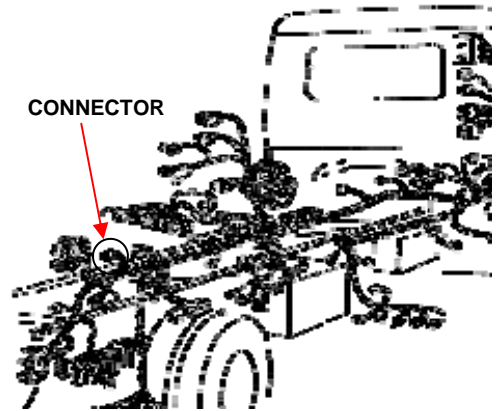

FIGURE 7

## UD1800CS ~ UD3300 WITH MANUAL TRANSMISSION

1. Connect the JANC PTO terminals together.

### EXTERNAL ENGINE THROTTLE CONTROL FUNCTION CHOICE:

- 2a. To operate the External Engine Throttle Control with PTO switch turned "ON" only:
  - Connect JANC A terminals together.
- 2b. To operate the External Engine Throttle Control with PTO switch turned either "ON" or "OFF":
  - Connect JANC A terminals together and JANC B terminals together.

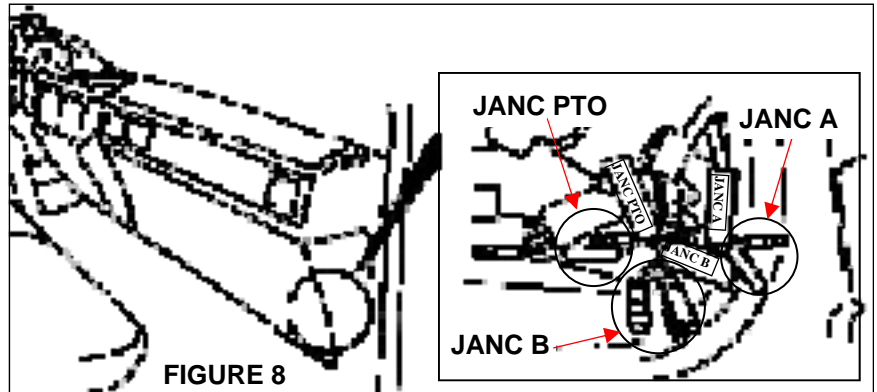

FIGURE 8

3. Install one (1) PTO relay.

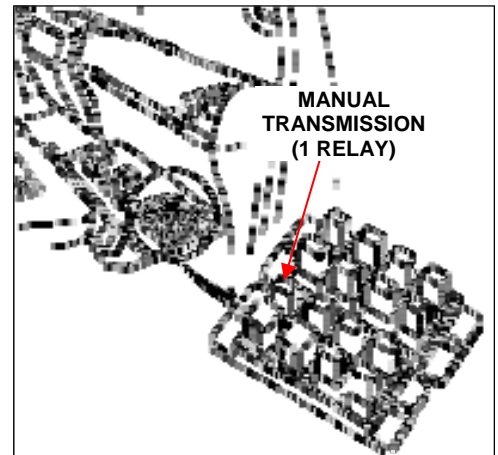

FIGURE 9

4. Connect the PTO magnetic valve to the chassis wiring harness connector located in the left frame rail near the transmission.

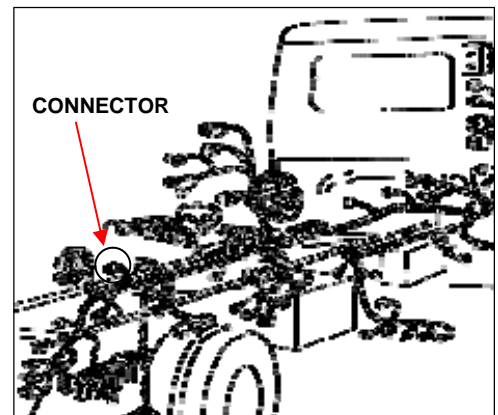

FIGURE 10

5. Install the clutch pedal switch and related parts as shown. The clutch switch connector is taped to the instrument harness wiring loom.

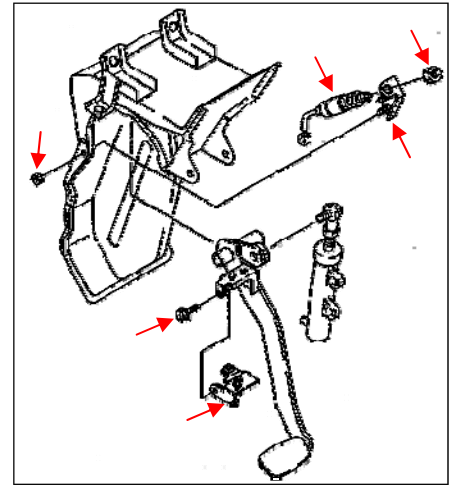

FIGURE 11

## UD1300/UDI400/UDI800CS WITH ATM

### EXTERNAL ENGINE THROTTLE CONTROL FUNCTION CHOICES:

1. To operate the External Engine Throttle Control with PTO switch turned "ON" only:
  - Do not connect JANC B.
2. To operate the External Engine Throttle Control with PTO switch turned either "ON" or "OFF":
  - Connect JANC B terminals together.

BEHIND THE RIGHT SIDE GLOVE BOX COMPARTMENT

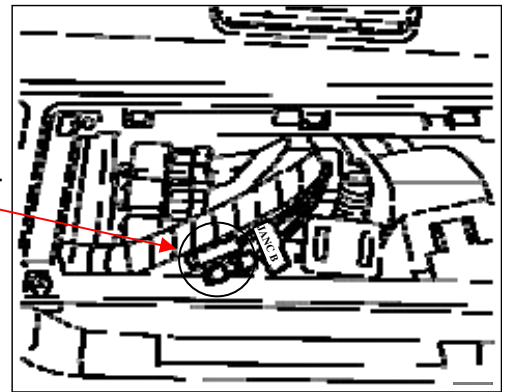

FIGURE 12

### EXTERNAL ENGINE THROTTLE CONTROL INSTALLATION

1. Mount the External Engine Throttle Control, part number 2376036D01, in a location to avoid direct contact with water. Install a protective cover to shield the External Engine Throttle Control sensor from road splash or rain/snow accumulation.

The External Engine Throttle Control should be mounted after the Installer has determined how it will be operated: either by a solenoid, manual lever or cable.

2. Finish routing and securing the extension sub-harness and connect it to the External Engine Throttle Control.

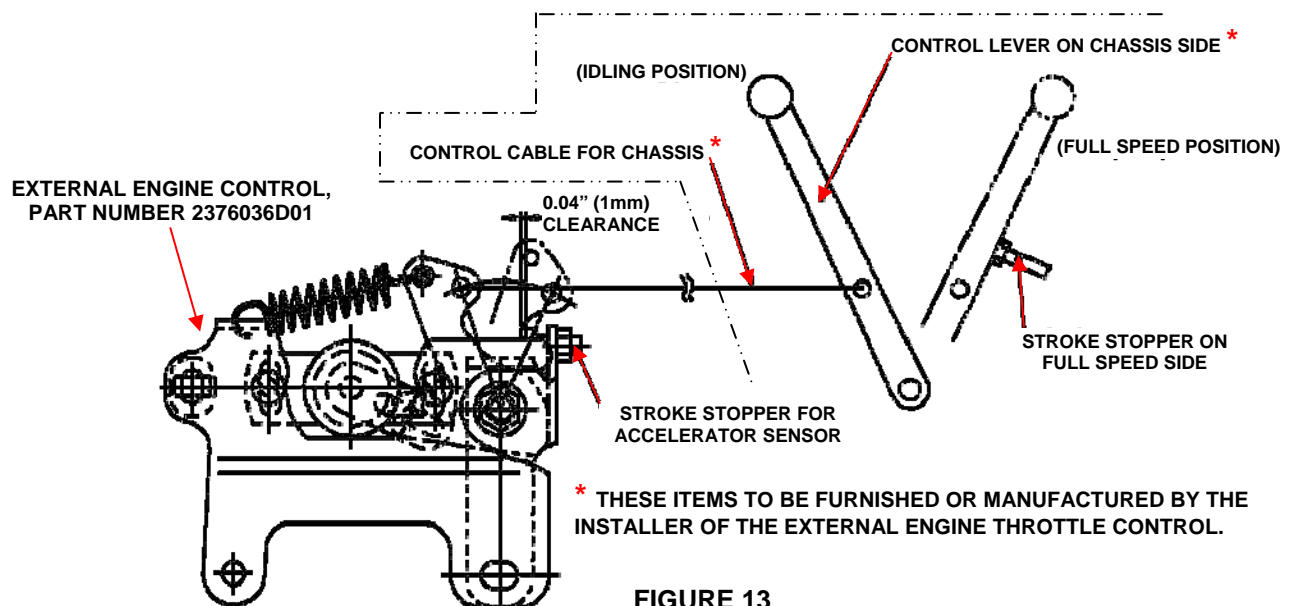
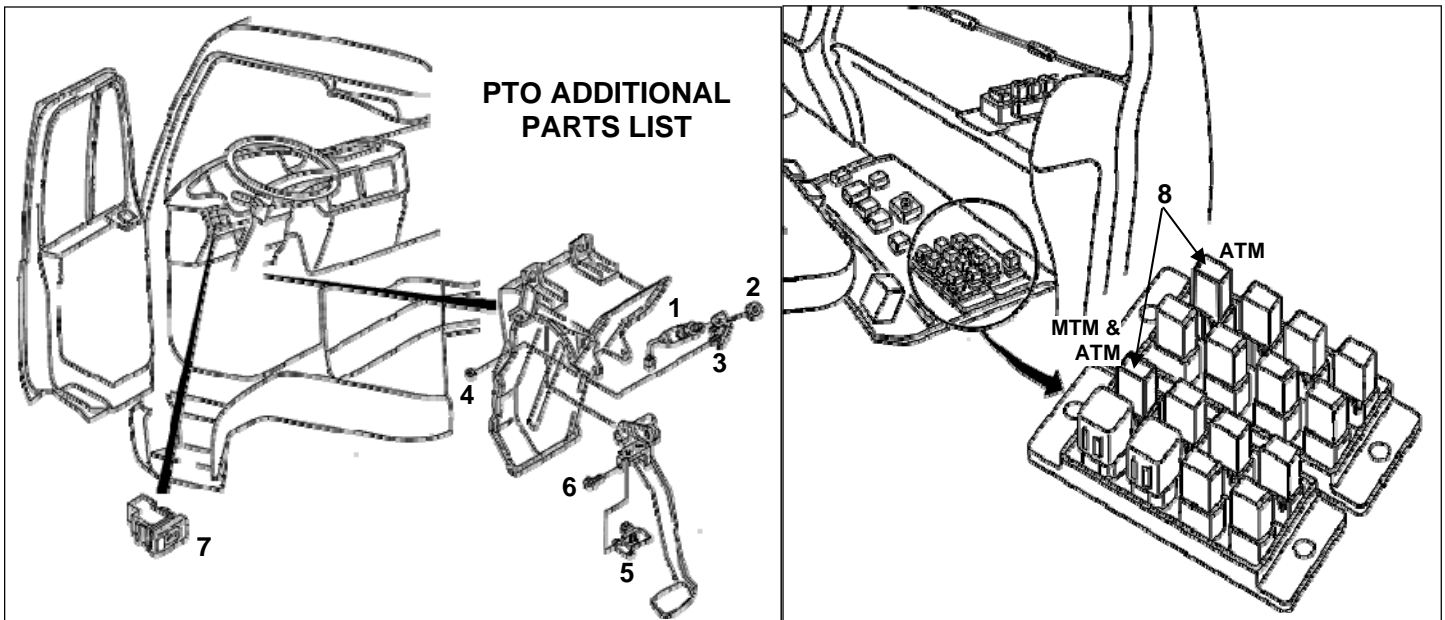

FIGURE 13

## ADJUSTMENTS

- Adjust the engine throttle control lever (see Figure 13) free-play so that the External Engine Throttle Control can return completely to the idle position.
- Set a minimal clearance of 0.04" (1 mm) between the External Engine Throttle Control sensor lever and the adjustment bolt at full throttle to avoid damage to the External Engine Throttle Control sensor (see Figure 13).

**WARNING:** Do not connect any other electrical component or item to the PTO switch wiring or the External Engine Throttle Control wiring. Damage to the engine control ECU can occur if other types of electrical devices are attached to these wires.



ITEM	DESCRIPTION	PART NUMBER	QTY.
1	PTO CLUTCH SWITCH	2531200Z03	1
2	NUT	MM934M12125	1
3	PTO CLUTCH SWITCH BRACKET	4647300Z00	1
4	NUT	MM6923M6	2
5	PTO CLUTCH SWITCH PLATE	2531400Z05	1
6	BOLT	083636162D	2
7	PTO DASH SWITCH	2516530Z00 (MEDIUM DUTY) 25165Z5900 (LIGHT DUTY)	1
8	PTO RELAY(S)	2523079917	1 (MTM) 2 (ATM)
FIGURE 13	EXTERNAL ENGINE THROTTLE CONTROL	2376036D01	1
NOT SHOWN	EXTENSION SUB-HARNESS	2402437Z04	1
AS REQUIRED	MAGNETIC VALVE (MEDIUM DUTY)	2633530Z0B	1

**THE INFORMATION CONTAINED IN THIS BULLETIN SHOULD NOT BE INTERPRETED AS THE BASIS FOR WARRANTY CLAIMS UNLESS SO DESIGNATED**